

Fender Neck Profiles

1st Fret / 12th Fret

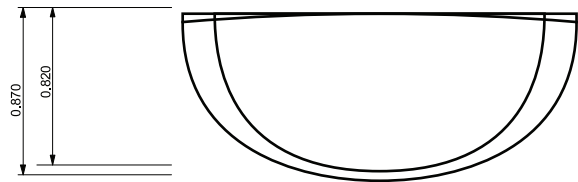

#19 - MODERN C

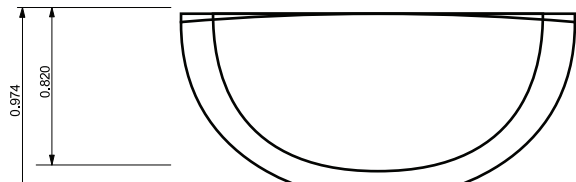

#29 - '65 STRAT C

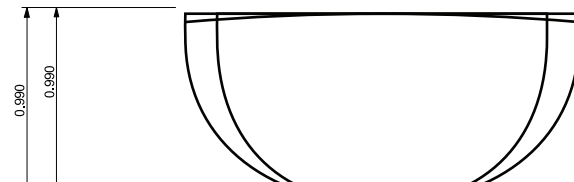

#1 - '52 STYLE U

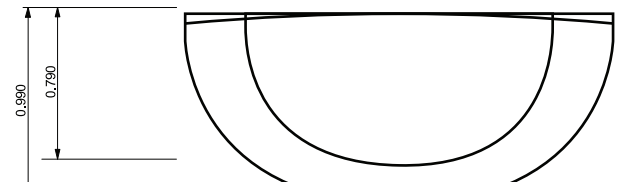

#8 - '60 J BASS U

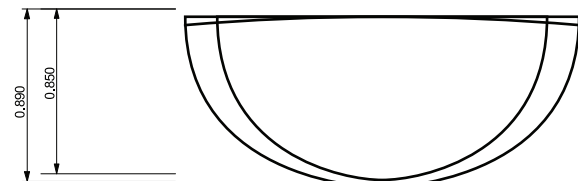

#20 - MODERN V

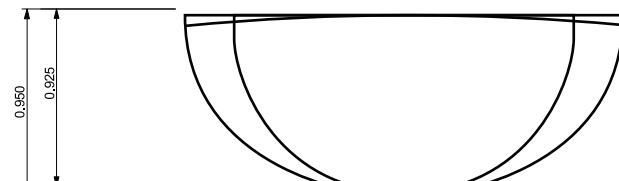

#30 - '55 P BASS SOFT V

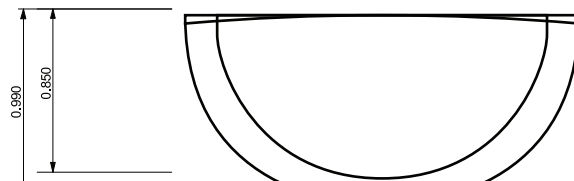

#2 - '57 STYLE SOFT V

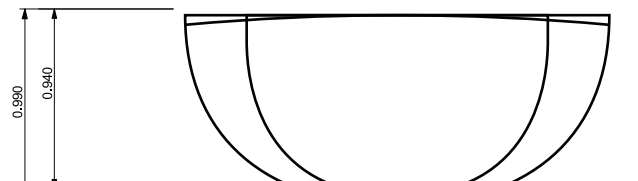

#12 - '51 P BASS U

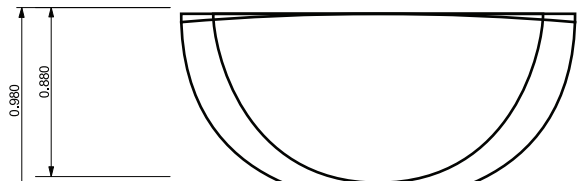

#23 - 10/56 V

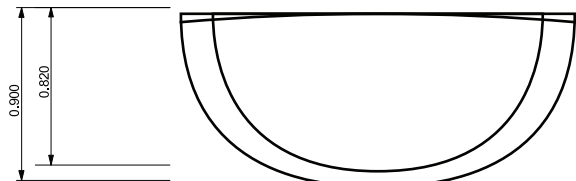

#36 - JAGUAR / JAZZMASTER C

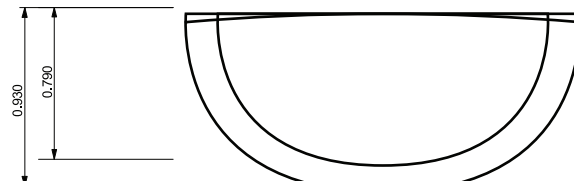

#3 - '60 STYLE OVAL C

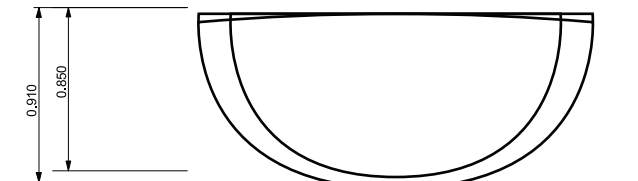

#13 - 1969 U

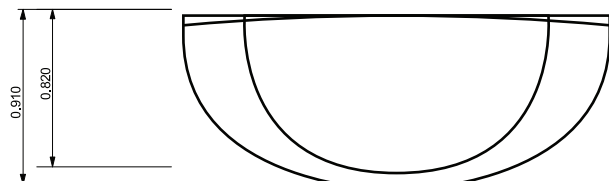

#26 - CC JAZZ BASS C

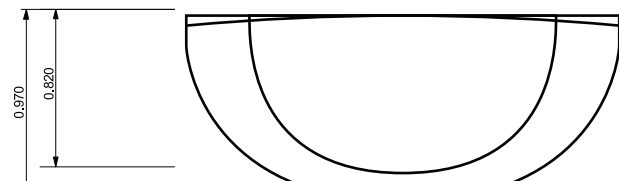

#40 - '75 JAZZ BASS

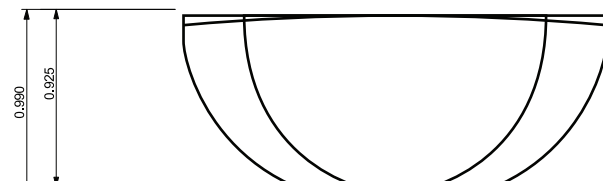

#6 - '57 BASS SOFT V

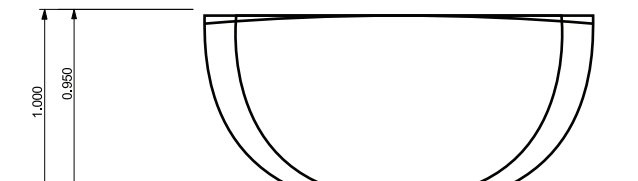

#14 - 1951 U

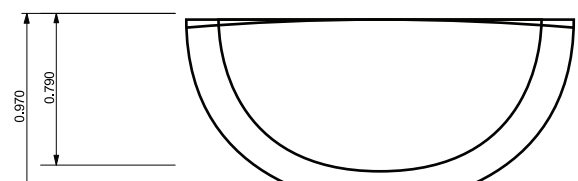

#28 - '59 C

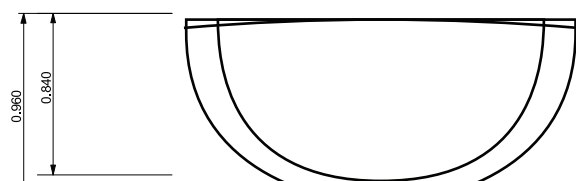

#51 - '66 STRAT OVAL C

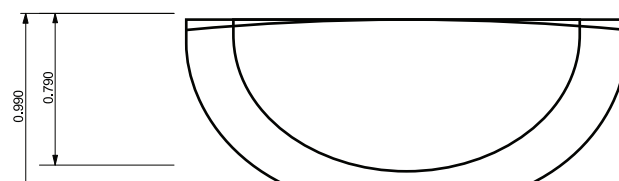

#7 - '60 P BASS OVAL C

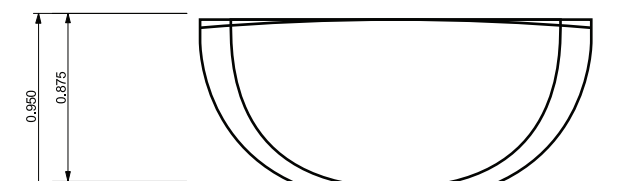

#18 - LARGE C